



High performance structural  
waterproofing for roofs, plazas &  
balconies

**PRIME GUARD**  
7000

**PITCHMASTIC** PmB

[www.primeresins.com](http://www.primeresins.com)



## All Encompassing Waterproofing

**Pitchmastic PmB** is a two-part, hybrid polyurethane elastomer for waterproofing. The spray-applied membrane gels in seconds to provide a seamless, fully adhered barrier to ingress of water and contaminants.

**Pitchmastic PmB** chemists have formulated a safe, user-friendly, and high-performing product.

**Pitchmastic PmB** offers clients the perfect balance between design, aesthetics and practical performance with a successful track record of more than 30 years worldwide.

### Spray Applied - No Weak Spots

Spray application means no seams or joints, eliminating potential weak spots. The result is a consistent, homogeneous waterproofing solution.

The client achieves the ultimate in protection and peace of mind.

### Manufactured in the U.S.A.

**Pitchmastic PmB** is manufactured in the U.S.A. and available nationwide via a network of approved applicators.

Each application is monitored by Prime Resins to ensure high quality installation and quality assurance.

#### Key to Symbols



Rapid curing



Chemically resistant



Approved applicators



Heavy duty



Longevity



Flexible

## Our Background



**Pioneered** the use of polyurethane resins for sealing cracks in concrete and helped build that market.



The first to package polyurethane grouts in an easy-to-use Quick-Mix cartridge system over **30 years ago.**

## Plaza Decks



Waterproofing under paving, water features and other hard landscaping to protect premises or infrastructure below.

## Roofing



A versatile monolithic system, ideal for waterproofing intricate detailing and penetrations. Compatible with most existing substrates. Suitable for green roofs.

## Balconies



Complete waterproofing of balconies either as a finished non-slip system or as a buried membrane under decking or paving.

## Stairs



Waterproofing under paving, water features and other hard landscaping to protect premises or infrastructure below.

## Tunnels & Walls

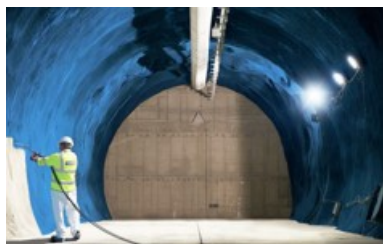

Waterproofing under paving, water features and other hard landscaping to protect premises or infrastructure below.

## Special Applications

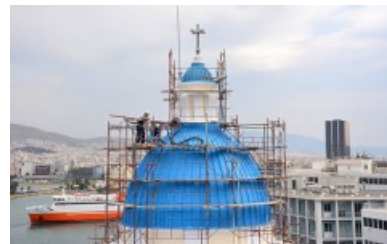

The ease of detailing and the versatility of the system makes it ideal for even the most intricate of waterproofing requirements.

# Durable & Safe Structural Waterproofing

The rapid-curing, spray-applied systems from Prime Resins, when installed directly onto the structural deck, have an unrivaled track record for long-term waterproofing of inverted and green roofs as well as plazas in prestigious developments.

Primer

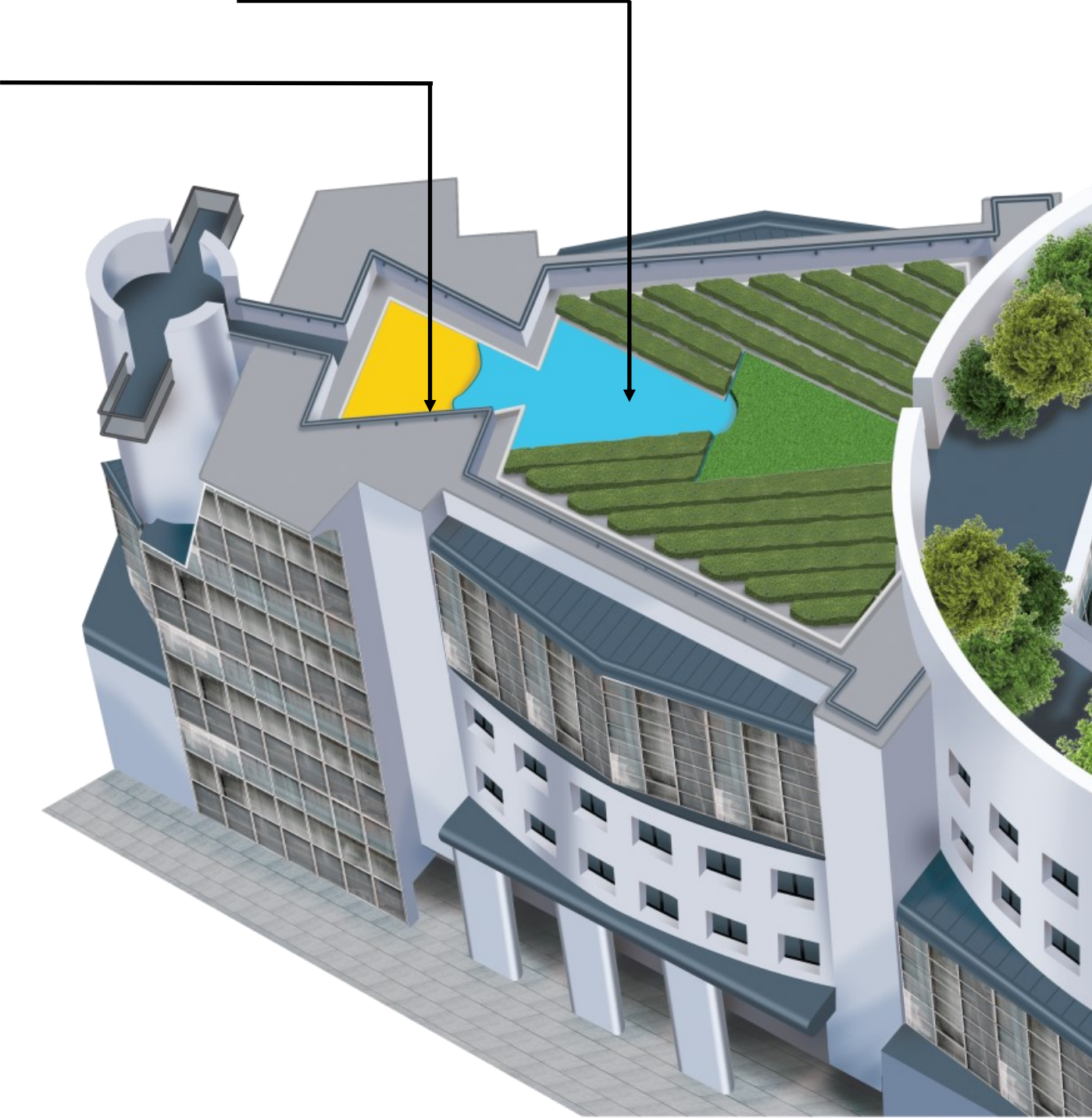

Roofs, plazas and balconies place very high demands on the waterproofing material used, particularly in areas over residential buildings, offices or production plants.

**Prime Resins waterproofing systems** offer many advantages compared to conventional waterproofing membranes. The spray-applied polyurethane system is long-lasting, withstands mechanical loads, and is totally weather resistant.

They can also be used underneath other coverings, such as gravel, timber decking, paving or grass. Its high resistance to hydrolysis means it can even be used in standing water applications, including water features and decorative pools.

## Applications

The Prime Resins waterproofing systems provide high performance fully-bonded waterproofing membranes for:

- Roofs
- Balconies
- Plazas
- Terraces

Their enhanced performance is ideal for:

- Landscaping
- Paved areas
- Planters
- Water features
- Green & brown roof applications
- Retention ponds

They also provide protection to:

- Basements
- Plant rooms
- Underground parking facilities
- Tunnels
- Secondary containment



# Durable & Safe Structural Waterproofing



**Pitchmastic PmB** is a rapid-curing, two-part, spray-applied, durable corrosion protection and waterproofing material. The high performance system contains no fillers or additives and is VOC-free. Once applied, it has exceptional bond strength to all commonly used substrates and has a life expectancy in excess of 30 years as a buried waterproofing system.



## Typical build-up of the Pitchmastic PmB roof system

- A- Concrete, steel, masonry surface
- B- Primer
- C- Pitchmastic PmB membrane

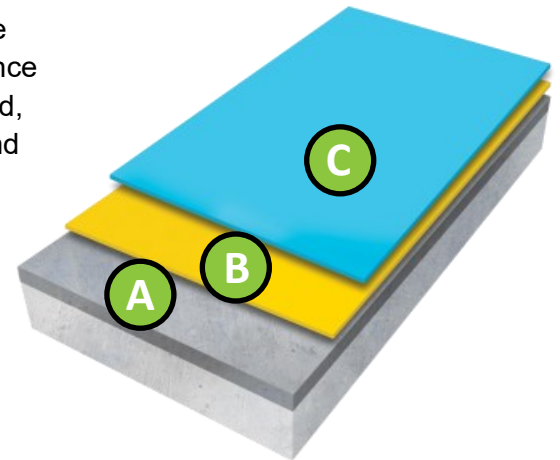

## PRIME GUARD 7000

**Prime Guard 7000** is an aromatic polyurea coating that is a high strength, hot spray-applied coating that offers ultimate durability, chemical and abrasion resistance and protection. This is a two-component, high solids content polyurea coating that passes ASTM G210 Severe Wastewater Analysis Testing, which evaluates protective barrier performance in corrosive sewer headspace environments.

## Key features and benefits of Prime Resins waterproofing systems:

- 100% effective with proven track record of more than 30 years
- Rapid installation and cure allow for application to horizontal, vertical and soffit surfaces
- Superior crack-bridging and adhesion properties
- Materials can be applied to new concrete (24 hours to 7 days old), at temperatures as low as 32°F
- Spray application ensures seamless protection around difficult detailing and penetrations.
- Prime Resins waterproofing systems require no pre-application termination joints or coves
- Low odor
- Excellent chemical resistance
- Fully tested puncture resistance capabilities
- Effective root barrier in landscaped areas and green roofs
- Suitable for use in areas permanently immersed in water

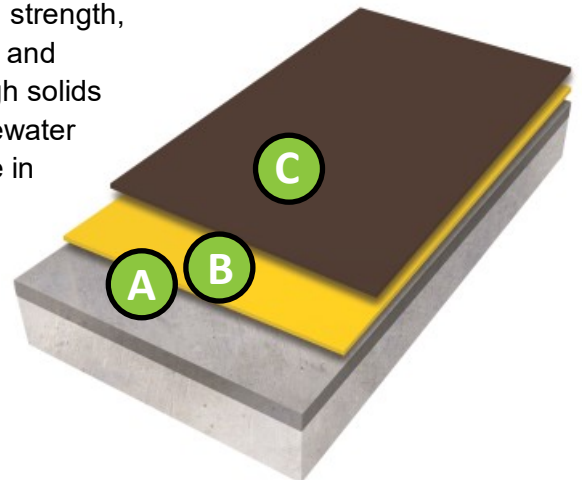

## Typical build-up of the Prime Bond 7000 system

- A- Concrete, steel, masonry surface
- B- Primer
- C- Prime Bond 7000 membrane

# Inverted System Suitable for Plazas & Terraces

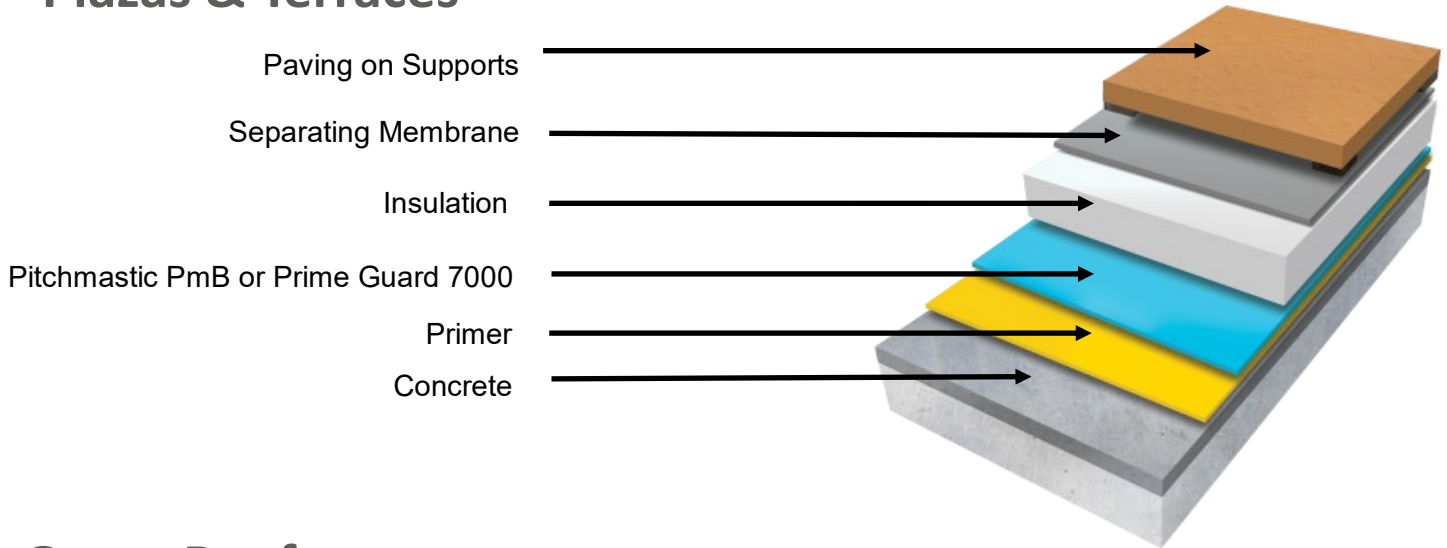

# Green Roofs

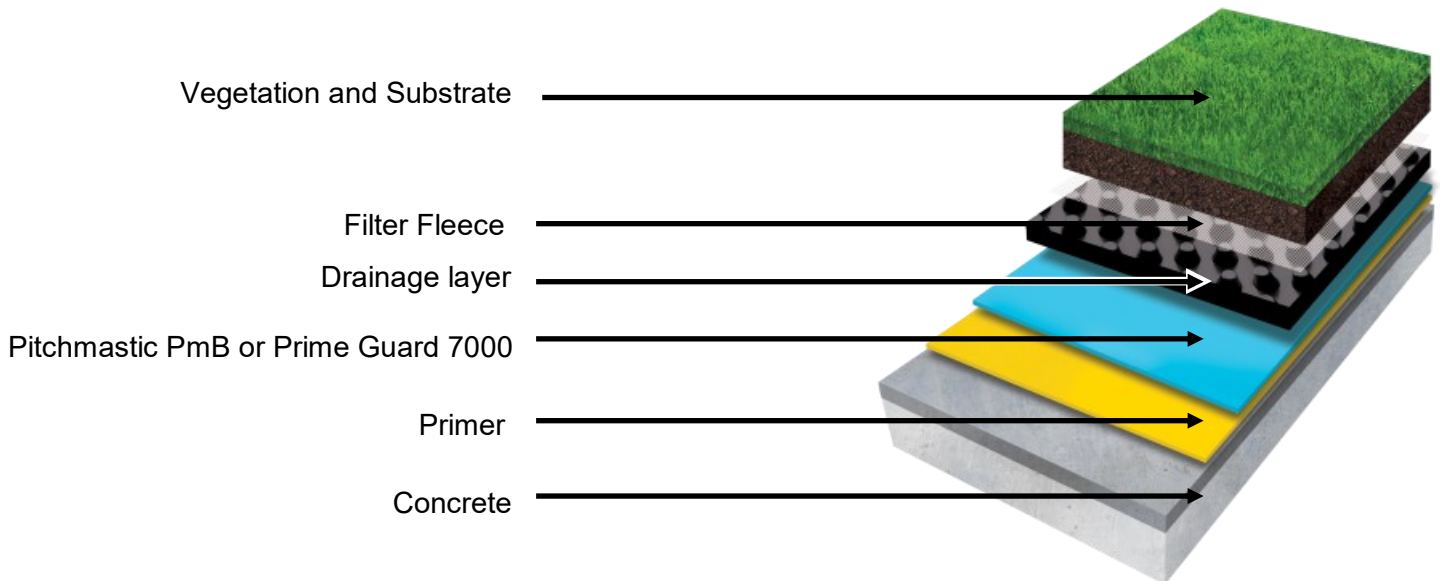

Prime Guard 7000 performs well in situations involving intricate detailing.

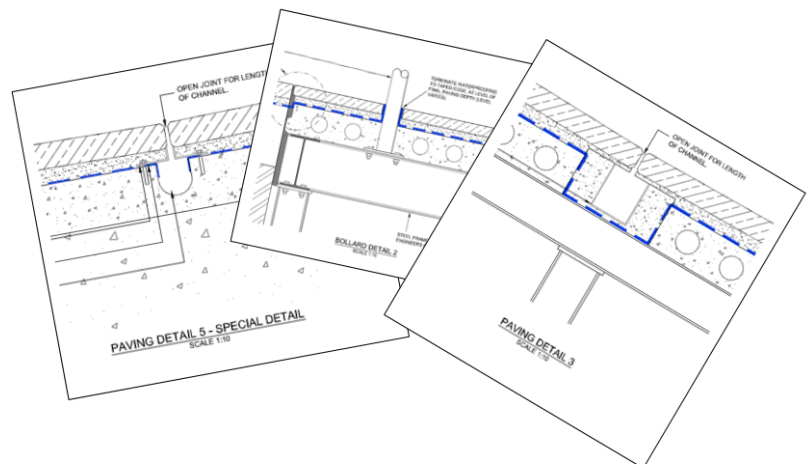



Working in partnership with

**PITCHMASTIC** PmB



Head Office

Prime Resins Inc.  
2291 Plunkett Road  
Conyers, GA 30012

T: 770-388-0626

E: [info@primeresins.com](mailto:info@primeresins.com)

W: [www.primeresins.com](http://www.primeresins.com)



Head Office

USL America  
2291 Plunkett Road  
Conyers, GA 30012

T: 770-388-0626

E: [info@uslamerica.com](mailto:info@uslamerica.com)

W: [www.uslamerica.com](http://www.uslamerica.com)

*USL America brings together under one umbrella some of the finest  
civil engineering and construction solutions available worldwide.*

A  Company

Rev. 3/29/19